

(PLEASE REMOVE BEFORE SIGNING - Appendix A – New Designation Order)

THE GREATER LONDON AUTHORITY
THE GLA SIDE ROADS (LONDON BOROUGH OF HARINGEY)
DESIGNATION ORDER 2007 VARIATION ORDER 2019

Made

November 2019

Commented [p1]: Insert day and month i.e. 10 February 2019 format

Coming into force

November 2019

The Mayor of London considers it expedient that certain roads in the London Borough of Haringey should become or cease to be GLA Side Roads. Therefore, the Greater London Authority, in exercise of the powers conferred by section 124B(2) of the Road Traffic Regulation Act 1984^a and of all other enabling powers, and with the consent of the Council of the London Borough of Haringey, hereby makes the following Order:

1. Citation and Commencement

This Order may be cited as the GLA Side Roads (London Borough of Haringey) Designation Order 2007 Variation Order 2019 and shall come into force on November 2019.

Commented [p2]: Insert day and month i.e. 10 February 2019 format

2. Variation

From the date on which this Order comes into force, the Schedule to the GLA Side Roads (London Borough of Haringey) Designation Order 2007, is varied as follows:

- (1) Under the heading "GLA Roads in London Borough of Haringey", immediately after item 1206, the following items are added:

Item No.	Route No.	Borough	Street Name	Description
1206a	A10	Haringey	Ermine Road	the north west side from a point on the extended north eastern building line of No 145 A10 High Road to a point 35 metres in a north westerly direction on Ermine Road.
1206b	A10	Haringey	Ermine Road	the south west side from a point on the extended north eastern building line of No 145 A10 High Road to a point 11 metres in a south westerly direction on Ermine Road.

^a 1980 c.66 – as amended by 1999 c.29

(PLEASE REMOVE BEFORE SIGNING - Appendix A – New Designation Order)

Item No.	Route No.	Borough	Street Name	Description
1206c	A10	Haringey	Ermine Road	the south west side from a point 2 metres from the extended southern building line of 57 and 58 to a point 4 metres in a northern direction.

Dated this of November 2019

Commented [p3]: Insert day and month i.e. 10 February 2019 format

Tim Steer,
Assistant Director of Transport, Infrastructure and Connectivity

Ermine Road - Plan

Proposal

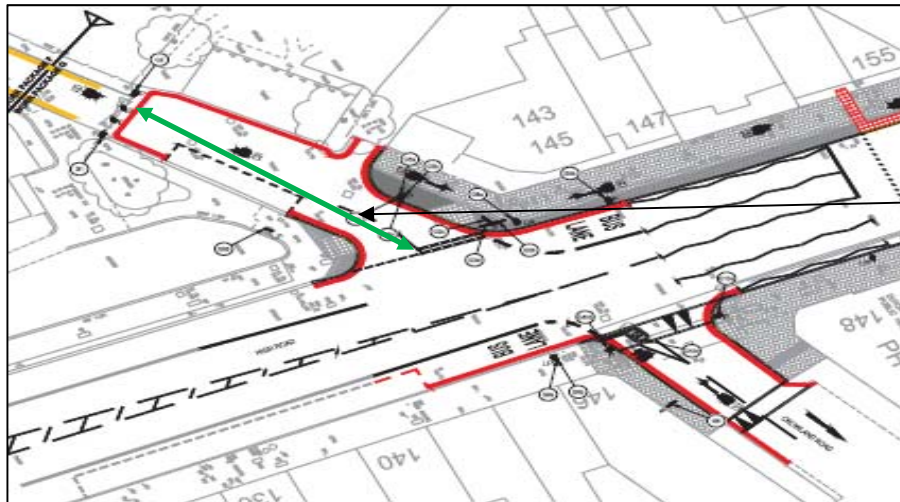

The length of carriageway depicted by the green arrow has been adopted as GLA Side Road to ease congestion entering and exiting Ermine Road.

Existing



THE GREATER LONDON AUTHORITY

THE GLA SIDE ROADS (LONDON BOROUGH OF HARINGEY) DESIGNATION ORDER 2007

Made 5/3/07

Coming into force 5/3/07

The Mayor of London considers it expedient that certain roads in the London Borough of Haringey should become or cease to be GLA Side Roads. Therefore, the Greater London Authority, in exercise of the powers conferred by section 124B(2) of the Road Traffic Regulation Act 1984^a and of all other enabling powers, and with the consent of the Council of the London Borough of Haringey, hereby makes the following Order:

1. Citation and Commencement

This Order may be cited as the GLA Side Roads (London Borough of Haringey) Designation Order 2007 and shall come into force on

2. Interpretation

In this Order any reference to "road" includes a length of road.

3. Revocation

The GLA Side Roads (London Borough of Haringey) Designation Order 2000^b is hereby revoked.

4. Direction

- (1) The Greater London Authority hereby directs that the roads defined in the schedule to this Order shall become GLA side roads.
- (2) The date on which the roads referred to in paragraph 3 shall be revoked and the date that the roads defined in the schedule to this Order shall become GLA Side Roads shall be the coming into force date cited above.

Dated this 5/3 day of 2007

Signed by
Mayor of London

^a 1984 c.27 – as amended by S.I 2000/2237

^b S.I 2000/1291



HEAD OF TRANSPORT

Greater London Authority
City Hall
The Queen's Walk
More London
London SE1 2AA

THE SCHEDULE

see Article 4

GLA SIDE ROADS IN THE LONDON BOROUGH OF HARINGEY

Side Roads Designation Order

Item no	Route no	Borough	Street name	Description
12	A1	Haringey	BISHOPS ROAD	the west side between its junction with Archway Road (A1) and a point 7 metres south of the extended southern building line of the Police Station, Archway Road
13	A1	Haringey	BISHOPS ROAD	the east side between its junction with Archway Road (A1) and a point 3 metres north of the extended north-western building line of Nos. 397 to 405 Archway Road
22	A1	Haringey	CAUSTON ROAD	the south-east side between its junction with Archway Road (A1) and a point 27 metres south-west of the extended south-western building line of Nos. 187 to 189 Archway Road
23	A1	Haringey	CAUSTON ROAD	the north-west side between its junction with Archway Road (A1) and a point 3 metres south-west of the extended south-western building line of Nos. 191 to 199 Archway Road
26	A1	Haringey	CHOLMELEY PARK	the north-west side between its junction with Archway Road (A1) and the extended common boundary of Nos. 2 and 4 Cholmeley Park
27	A1	Haringey	CHOLMELEY PARK	the south-east side between its junction with Archway Road (A1) and a point 2 metres south-west of the extended north-western building line of No. 223 Archway Road
28	A1	Haringey	CHURCH ROAD	the north-west side between its junction with Archway Road (A1) and a point 5 metres north-east of the extended south westernmost building line of No. 411 Archway Road

Side Roads Designation Order

Item no	Route no	Borough	Street name	Description
29	A1	Haringey	CHURCH ROAD	the south-east side between its junction with Archway Road (A1) and a point 4 metres north-east of the extended north-eastern building line of Telfer House, Church Road
32	A1	Haringey	CROMWELL AVENUE	the north-west side between its junction with Archway Road (A1) and the extended common boundary of Nos. 4 and 6 Cromwell Avenue
33	A1	Haringey	CROMWELL AVENUE	the south-east side between its junction with Archway Road (A1) and a point 4 metres north-east of the extended south-western building line of No. 177 Archway Road
64	A1	Haringey	GREAT NORTH ROAD	the north-east side between its junction with Archway Road (A1) and a point 11 metres north-west of the extended common boundary of Nos. 4 and 6 Great North Road
65	A1	Haringey	GREAT NORTH ROAD	the south-west side between its junction with Aylmer Road (A1) and the extended common boundary of Nos. 18 and 19 Aylmer Parade, Aylmer Road
78	A1	Haringey	HIGHGATE AVENUE	the east side between its junction with Archway Road (A1) and a point 7 metres south of the extended southern building line of No. 269 Archway Road
79	A1	Haringey	HIGHGATE AVENUE	the west side between its junction with Archway Road (A1) and a point 6 metres north of the extended common boundary of Nos. 2 and 4 Highgate Avenue
86	A1	Haringey	HOLMESDALE ROAD	the north side between its junction with Archway Road (A1) and a point 5 metres north-east of the extended south-western building line of The Birkbeck (PH), Holmesdale Road
87	A1	Haringey	HOLMESDALE ROAD	the south side between its junction with Archway Road (A1) and a point 1 metre east of the extended north-eastern building line of No. 310 Archway Road

Side Roads Designation Order

Item no	Route no	Borough	Street name	Description
95	A1	Haringey	JACKSON'S LANE	the north-west side between its junction with Archway Road (A1) and the extended north-eastern building line of Nos. 1 to 8 Jackson's Lane
96	A1	Haringey	JACKSON'S LANE	the south-east side between its junction with Archway Road (A1) and the extended common boundary of Nos. 1 and 3 Jackson's Lane
105	A1	Haringey	LANGDON PARK ROAD	the north side between its junction with Archway Road (A1) and a point 5 metres north-east of the extended south-western building line of No. 162 Archway Road
106	A1	Haringey	LANGDON PARK ROAD	the south side between its junction with Archway Road (A1) and a point 13 metres north-east of the extended south-western building line of St. Augustine's Church, Archway Road
125	A1	Haringey	MUSWELL HILL ROAD	the west side between its junction with Archway Road (A1) and a point 44 metres south of a point opposite the southernmost building line of Nos. 1 to 9 Southwood Hall, Muswell Hill Road
126	A1	Haringey	MUSWELL HILL ROAD	the north-east side between its junction with Archway Road (A1) and a point 41 metres south-west of the extended common boundary of Nos. 2 and 4 Wood Lane
129	A1	Haringey	NORTHWOOD ROAD	the north side between its junction with Archway Road (A1) and a point 1 metre south-west of the extended north-eastern building line of No. 208 Archway Road
130	A1	Haringey	NORTHWOOD ROAD	the south side between its junction with Archway Road (A1) and a point 2 metres south-west of the extended north-eastern building line of No. 206 (PH) The Winchester Hall Hotel, Archway Road
145	A1	Haringey	SHEPHERD'S HILL	the north-west side between its junction with Archway Road (A1) and a point 2 metres north-east of a point opposite the extended south westernmost building line of Nos. 1 to 16 Goldsmith's Court, Archway Road

Side Roads Designation Order

Item no	Route no	Borough	Street name	Description
146	A1	Haringey	SHEPHERD'S HILL	the south-east side between its junction with Archway Road (A1) and a point 3 metres south-west of the extended south westernmost building line of Nos. 1 to 16 Goldsmith's Court, Archway Road
147	A1	Haringey	SOUTHWOOD AVENUE	the north-west side between its junction with Archway Road (A1) and a point 16 metres north-east of the extended common boundary of Nos. 2 and 4 Southwood Avenue
148	A1	Haringey	SOUTHWOOD AVENUE	the south-east side between its junction with Archway Road (A1) and a point 1 metre south-west of the extended north-eastern building line of No. 233 Archway Road
149	A1	Haringey	SOUTHWOOD LANE	the west side between its junction with Archway Road (A1) and a point 9 metres south of the northern building line of Nos. 153 to 163 Southwood Lane
150	A1	Haringey	SOUTHWOOD LANE	the east side between its junction with Archway Road (A1) and a point 5 metres south of the extended north-eastern building line of Nos. 1 to 8 Southwood Mansions, Southwood Lane
163	A1	Haringey	TALBOT ROAD	the north-west side between its junction with Archway Road (A1) and a point 2 metres south-west of the extended north-eastern building line of No. 469 Archway Road
164	A1	Haringey	TALBOT ROAD	the south-east side between its junction with Archway Road (A1) and a point 2 metres south-west of the extended north-eastern building line of No. 467 Archway Road
1083	A10	Haringey	ACACIA AVENUE	the north side between its junction with Great Cambridge Road (A10) and a point 3 metres east of the extended western building line of St. John the Baptist Church, Acacia Avenue
1084	A10	Haringey	ACACIA AVENUE	the south side between its junction with Great Cambridge Road (A10) and a point 1 metre east of the extended eastern building line of No. 64 Great Cambridge Road

Side Roads Designation Order

Item no	Route no	Borough	Street name	Description
1087	A10	Haringey	ALL HALLOWS ROAD	the north side between its junction with The Roundway (A10) and a point 22 metres east of the extended easternmost building line of No. 309 The Roundway
1088	A10	Haringey	ALL HALLOWS ROAD	the south side between its junction with The Roundway (A10) and a point 8 metres west of the extended common boundary of Nos. 2 and 4 All Hallows Road
1093	A10	Haringey	ANTILL ROAD	the north side between its junction with Broad Lane (A10) and a point 8 metres west of the extended eastern building line of Nos. 193 to 197 Broad Lane
1094	A10	Haringey	ANTILL ROAD	the south side between its junction with Broad Lane (A10) and a point 8 metres west of the extended eastern building line of Nos. 189 to 191 Broad Lane
1095	A10	Haringey	ANTILL ROAD	the east side between its junction with Broad Lane (A10) and a point 21 metres north of the extended southern building line of No. 105 Fountayne Road
1096	A10	Haringey	ANTILL ROAD	the west side between its junction with Broad Lane (A10) and a point 20 metres north of the extended southern building line of No. 103 Fountayne Road
1101	A10	Haringey	AWLFIELD AVENUE	the north-west side between its junction with The Roundway (A10) and a point 5 metres south-west of the extended south-western building line of No. 259 The Roundway
1102	A10	Haringey	AWLFIELD AVENUE	the south-east side between its junction with The Roundway (A10) and a point 4 metres south-west of the extended south-western building line of No. 261 The Roundway
1103	A10	Haringey	AWLFIELD AVENUE	the north-west side between its junction with The Roundway (A10) and a point 16 metres north-east of the extended north-eastern building line of No. 228 The Roundway

Side Roads Designation Order

Item no	Route no	Borough	Street name	Description
1104	A10	Haringey	AWLFIELD AVENUE	the south-east side between its junction with The Roundway (A10) and a point 14 metres north-east of the extended north-eastern building line of No. 230 The Roundway
1130	A10	Haringey	BROADWATER ROAD	the east side between its junction with Lordship Lane (A10) and a point 4 metres north of the extended northern building line of No. 1 Broadwater Road
1131	A10	Haringey	BROADWATER ROAD	the west side between its junction with Lordship Lane (A10) and a point 10 metres north of the extended common boundary of Nos. 2 and 4 Broadwater Road
1148	A10	Haringey	CAMBRIDGE GARDENS	between its junction with Great Cambridge Road (A10) and a point 2 metres west of the extended eastern building line of No. 51 Great Cambridge Road
1156	A10	Haringey	CHESNUT ROAD	the north-east side between its junction with High Road (A10) and a point 13 metres south-east of the extended eastern building line of No. 400 High Road
1157	A10	Haringey	CHESNUT ROAD	the south-west side between its junction with High Road (A10) and a point 5 metres west of the extended south-eastern building line of Police Station, High Road
1158	A10	Haringey	CHURCH LANE	the west side between its junction with Lordship Lane (A10) and a point 3 metres north of the extended southern building line of No. 58 Lordship Lane
1159	A10	Haringey	CHURCH LANE	the east side between its junction with Lordship Lane (A10) and a point 3 metres north of a point opposite the extended southern building line of No. 58 Lordship Lane
1164	A10	Haringey	COLSTERWORTH ROAD	the north side between its junction with High Road (A10) and a point 1 metre west of the extended western building line of No. 312 Colsterworth Road

Side Roads Designation Order

Item no	Route no	Borough	Street name	Description
1165	A10	Haringey	COLSTERWORTH ROAD	the south side between its junction with High Road (A10) and a point 20 metres west of the extended common boundary of Nos. 2a to 2b Colsterworth Road and No. 4a Colsterworth Road
1166	A10	Haringey	COMPTON CRESCENT	the north side between its junction with Great Cambridge Road (A10) and a point 8 metres south-west of the extended eastern building line of Nos. 1 to 7 Pele Court, Great Cambridge Road
1167	A10	Haringey	COMPTON CRESCENT	the south side between its junction with Great Cambridge Road (A10) and a point 1 metre east of a point opposite the extended eastern building line of Nos. 1 to 7 Pele Court, Great Cambridge Road
1172	A10	Haringey	CRAVEN PARK ROAD	the north-west side between its junction with High Road (A10) and a point 2 metres east of the extended western building line of Nos. 2 to 6 High Road
1173	A10	Haringey	CRAVEN PARK ROAD	the south-east side between its junction with Stamford Hill (A10) and a point 5 metres east of the extended south-western building line of No. 296 Stamford Hill
1178	A10	Haringey	CROWLAND ROAD	the north side between its junction with High Road (A10) and a point 7 metres south-west of the extended north-eastern-building line of Nos. 148 to 154 PH, High Road
1179	A10	Haringey	CROWLAND ROAD	the south-east side between its junction with High Road (A10) and the extended north-eastern building line of No. 146 High Road
1180	A10	Haringey	CUNNINGHAM ROAD	the east side between its junction with Broad Lane (A10) and a point 5 metres south of the extended southern building line of Nos. 1 to 9 St. Peters House, Fountayne Road
1181	A10	Haringey	CUNNINGHAM ROAD	the west side between its junction with Broad Lane (A10) and a point 5 metres north of the extended southern building line of No. 123 Broad Lane

Side Roads Designation Order

Item no	Route no	Borough	Street name	Description
1185	A10	Haringey	DEVONSHIRE HILL LANE (EAST ARM)	between its junction with Great Cambridge Road (A10) and a point 6 metres east of the extended western building line of No. 76 Great Cambridge Road
1186	A10	Haringey	DEVONSHIRE HILL LANE (WEST ARM)	between its junction with Great Cambridge Road (A10) and the extended eastern building line of No. 73 Great Cambridge Road
1205	A10	Haringey	ELMHURST ROAD	the north-west side between its junction with Bruce Grove (A10) and a point 12 metres south-west of the extended north-eastern building line of No. 27 Bruce Grove
1206	A10	Haringey	ELMHURST ROAD	the south-east side between its junction with Bruce Grove (A10) and a point 7 metres south-west of the extended north-eastern building line of No. 25 Bruce Grove
1224	A10	Haringey	FERNDALE ROAD	the north-west side between its junction with High Road (A10) and a point 2 metres north-east of the extended eastern building line of No. 130 High Road
1225	A10	Haringey	FERNDALE ROAD	the south-east side between its junction with High Road (A10) and the extended south-western building line of Nos. 2 to 2b Ferndale Road
1226	A10	Haringey	FERRY LANE	the south side between its junction with The Hale (A10) and a point 27 metres north-west of the extended eastern building line of No. 8 Tottenham Hale Retail Park, Broad Lane
1227	A10	Haringey	FERRY LANE	the north side between its junction with The Hale (A10) and a point 44 metres south-east of the intersection of the extended south-eastern kerbline of Station Road and the extended north-eastern kerbline of The Hale
1230	A10	Haringey	FLEXMERE ROAD	the west side between its junction with The Roundway (A10) and a point 2 metres south of the extended south-western building line of No. 299 The Roundway

Side Roads Designation Order

Item no	Route no	Borough	Street name	Description
1231	A10	Haringey	FLEXMERE ROAD	the east side between its junction with The Roundway (A10) and the extended south-western building line of No. 301 The Roundway
1234	A10	Haringey	FOREST GARDENS	the north-west side between its junction with Bruce Grove (A10) and a point 2 metres north-east of the extended north-eastern building line of Nos. 87 to 88 Bruce Grove
1235	A10	Haringey	FOREST GARDENS	the south-east side between its junction with Bruce Grove (A10) and a point 6 metres north-east of the extended north-eastern building line of Nos. 89 to 90 Bruce Grove
1238	A10	Haringey	FORSTER ROAD	the north side between its junction with High Road (A10) and a point 2 metres east of the extended western building line of Nos. 455 to 457 High Road
1239	A10	Haringey	FORSTER ROAD	the south side between its junction with High Road (A10) and the extended common boundary of Nos. 451 to 453 High Road and No. 1 Forster Road
1242	A10	Haringey	FOUNTAYNE ROAD	the south side between its junction with Broad Lane (A10) and a point 15 metres west of the extended common boundary of Nos. 1 and 2 Fountayne Road
1243	A10	Haringey	FOUNTAYNE ROAD	the north side between its junction with Broad Lane (A10) and a point 26 metres east of the extended western building line of No. 12 Ventnor Terrace, Shanklin Road
1244	A10	Haringey	FRYATT ROAD	the north-west side between its junction with The Roundway (A10) and a point 1 metre south-west of the extended south-western building line of No. 211 The Roundway
1245	A10	Haringey	FRYATT ROAD	the south-east side between its junction with The Roundway (A10) and a point 13 metres south-west of the extended south-western building line of No. 39 Fryatt Road

Side Roads Designation Order

Item no	Route no	Borough	Street name	Description
1251	A10	Haringey	GLADESMORE ROAD	the north-west side between its junction with High Road (A10) and a point 10 metres south-west of the extended common boundary of Nos. 1 and 2 Gladesmore Road
1252	A10	Haringey	GLADESMORE ROAD	the south-east side between its junction with High Road (A10) and a point 7 metres north-east of the extended western building line of No. 92 High Road
1257	A10	Haringey	HALE ROAD	the north side between its junction with The Hale (A10) and the extended common boundary of Nos. 1 and 3 Hale Road
1258	A10	Haringey	HALE ROAD	the south side between its junction with The Hale (A10) and a point 1 metre south-east of a point opposite the extended common boundary of Nos. 7 and 9 Hale Road
1259	A10	Haringey	HANOVER ROAD	the east side between its junction with Broad Lane (A10) and a point 6 metres north of the extended southern building line of No. 73 Fountayne Road
1260	A10	Haringey	HANOVER ROAD	the west side between its junction with Broad Lane (A10) and a point 6 metres south of the extended northern building line of No. 71 Broad Lane
1262	A10	Haringey	HARTHAM ROAD	the north-west side between its junction with Bruce Grove (A10) and the extended south-western building line of No. 68e (Nurses' Home), Bruce Grove
1263	A10	Haringey	HARTHAM ROAD	the south-east side between its junction with Bruce Grove (A10) and a point 2 metres south-west of the extended north-eastern building line of No. 68d Bruce Grove
1265	A10	Haringey	HENNINGHAM ROAD	the north-west side between its junction with The Roundway (A10) and the extended common boundary of No. 233 The Roundway and No. 45 Henningham Road

Side Roads Designation Order

Item no	Route no	Borough	Street name	Description
1266	A10	Haringey	HENNINGHAM ROAD	the south-east side between its junction with The Roundway (A10) and a point 2 metres north-east of the extended common boundary of No. 235 The Roundway and No. 60 Henningham Road
1267	A10	Haringey	HENNINGHAM ROAD	the north-west side between its junction with The Roundway (A10) and a point 2 metres north-east of the extended common boundary of Nos. 200 and 202 The Roundway
1268	A10	Haringey	HENNINGHAM ROAD	the south-east side between its junction with The Roundway (A10) and a point 3 metres north-east of the extended common boundary of Nos. 204 and 206 The Roundway
1269	A10	Haringey	HIGH CROSS ROAD	the north side between its junction with The Hale (A10) and a point 6 metres north-east of the extended north-eastern building line of Nos. 165 to 179 Cape Road
1270	A10	Haringey	HIGH CROSS ROAD	the south side between its junction with The Hale (A10) and a point 4 metres north-east of the extended north-eastern building line of Nos. 32 to 86 Hale Gardens
1271	A10	Haringey	HIGH ROAD	the west side between its junction with High Road and Bruce Grove and a point 1 metre north of the extended common boundary of Nos. 523 and 525 High Road
1272	A10	Haringey	HIGH ROAD	the east side between its junction with High Road and Bruce Grove and a point 7 metres north of the extended common boundary of No. 520 High Road and Nos. 522 to 528 High Road
1273	A10	Haringey	HILLSIDE ROAD	the north side between its junction with High Road (A10) and the extended eastern building line of No. 19 High Road
1274	A10	Haringey	HILLSIDE ROAD	the south side between its junction with High Road (A10) and a point 1 metre west of the extended eastern building line of No. 17 High Road

Side Roads Designation Order

Item no	Route no	Borough	Street name	Description
1287	A10	Haringey	LABURNUM AVENUE	between its junction with Great Cambridge Road (A10) and a point 1 metre west of the extended western building line of No.66 Great Cambridge Road
1295	A10	Haringey	LEALAND ROAD	the north-west side between its junction with High Road (A10) and a point 9 metres north-east of the extended eastern building line of Nos. 112 to 116 (Surgery), High Road
1296	A10	Haringey	LEALAND ROAD	the south-east side between its junction with High Road (A10) and the extended north-eastern building line of No. 110 High Road
1304	A10	Haringey	LINLEY ROAD	the north-west side between its junction with Bruce Grove (A10) and a point 1 metre south-west of the extended north-eastern building line of No. 49 Bruce Grove
1305	A10	Haringey	LINLEY ROAD	the south-east side between its junction with Bruce Grove (A10) and a point 1 metre south-west of the extended north-eastern building line of No. 48 Bruce Grove
1313	A10	Haringey	LORDSHIP LANE	the north-west side between its junction with Lordship Lane and Bruce Grove and a point opposite the extended north-western building line of Nos. 1 to 6 Bruce Castle Court, Bruce Grove
1314	A10	Haringey	LORDSHIP LANE	the south-east side between its junction with Lordship Lane and Bruce Grove and a point 4 metres east of the extended north-western building line of Nos. 1 to 6 Bruce Castle Court, Bruce Grove
1315	A10	Haringey	LORDSHIP LANE	the south side between its junction with Lordship Lane and The Roundway and a point 1 metre east of the extended common boundary of Nos. 149 and 151 Lordship Lane
1316	A10	Haringey	LORDSHIP LANE	the north side between its junction with Lordship Lane and The Roundway and a point 3 metres east of the extended common boundary of Nos. 80 and 82 Lordship Lane

Side Roads Designation Order

Item no	Route no	Borough	Street name	Description
1321	A10	Haringey	MARKFIELD ROAD	the east side between its junction with Broad Lane (A10) and a point 6 metres south of the extended northern building line of No. 158 (PH), Broad Lane
1322	A10	Haringey	MARKFIELD ROAD	the west side between its junction with Broad Lane (A10) and a point 2 metres north of the extended northernmost building line of Nos. 110 to 156 Broad Lane
1323	A10	Haringey	MAYFAIR GARDENS	between its junction with Great Cambridge Road (A10) and the extended eastern building line of No. 101 Great Cambridge Road
1331	A10	Haringey	MOOREFIELD ROAD	the south-east side between its junction with Bruce Grove (A10) and a point 35 metres south of a point opposite the extended north-eastern building line of Nos. 1 to 2 Station Buildings, Moorefield Road
1332	A10	Haringey	MOOREFIELD ROAD	the north-west side between its junction with Bruce Grove (A10) and a point 31 metres south-west of the extended north-eastern building line of Nos. 1 to 2 Station Buildings, Moorefield Road
1336	A10	Haringey	NORFOLK AVENUE	the north-west side between its junction with High Road (A10) and the extended eastern building line of No. 56 High Road
1337	A10	Haringey	NORFOLK AVENUE	the south-east side between its junction with High Road (A10) and a point 6 metres south-west of the extended south-western building line of No. 2 Norfolk Avenue
1350	A10	Haringey	PARK VIEW ROAD	the west side between its junction with The Hale (A10) and a point 8 metres south of the extended northern building line of Community Centre, Monument Way
1351	A10	Haringey	PARK VIEW ROAD	the east side between its junction with The Hale (A10) and a point 5 metres south of a point opposite the extended northern building line of Community Centre, Monument Way

Side Roads Designation Order

Item no	Route no	Borough	Street name	Description
1355	A10	Haringey	PHILIP LANE	the south side between its junction with High Road (A10) and a point 2 metres west of a point opposite the extended western building line of No. 6 Philip Lane
1356	A10	Haringey	PHILIP LANE	the north side between its junction with High Road (A10) and the extended western building line of No. 6 Philip Lane
1366	A10	Haringey	RADLEY ROAD	the north-west side between its junction with Bruce Grove (A10) and a point 1 metre south-west of the extended north-eastern building line of No. 38 Bruce Grove
1367	A10	Haringey	RADLEY ROAD	the south-east side between its junction with Bruce Grove (A10) and a point 2 metres south-west of the extended north-eastern building line of No. 37 Bruce Grove
1379	A10	Haringey	ROSTREVOR AVENUE	the north-west side between its junction with High Road (A10) and a point 3 metres south-west of the extended south-western building line of No. 1 Rostrevor Avenue
1380	A10	Haringey	ROSTREVOR AVENUE	the south-east side between its junction with High Road (A10) and a point 5 metres east of the extended eastern building line of No. 14 High Road
1391	A10	Haringey	SOMERSET ROAD	the north side between its junction with High Road (A10) and a point 10 metres west of the extended eastern building line of No. 372 High Road
1392	A10	Haringey	SOMERSET ROAD	the south side between its junction with High Road (A10) and a point 12 metres east of a point opposite the extended western building line of No. 372 High Road
1397	A10	Haringey	SPRINGFIELD ROAD	the north side between its junction with Broad Lane (A10) and a point 7 metres west of the extended eastern building line of Nos. 173 to 175 Broad Lane

Side Roads Designation Order

Item no	Route no	Borough	Street name	Description
1398	A10	Haringey	SPRINGFIELD ROAD	the south side between its junction with Broad Lane (A10) and a point 3 metres west of the extended eastern building line of No. 171 Broad Lane
1399	A10	Haringey	ST ANNIS ROAD	the north side between its junction with High Road (A10) and a point 11 metres west of the extended western building line of Nos. 2 to 24 (Surgery), St. Ann's Road
1400	A10	Haringey	ST ANNIS ROAD	the south side between its junction with High Road (A10) and a point 5 metres west of the extended eastern building line of St. Ignatius' RC Primary School, High Road
1401	A10	Haringey	ST LOY'S ROAD	the north side between its junction with High Road (A10) and the extended common boundary of Nos. 2a and 4 St. Loy's Road
1402	A10	Haringey	ST LOY'S ROAD	the south side between its junction with High Road (A10) and the extended common boundary of Nos. 3 and 5 St Loy's Road
1405	A10	Haringey	STAMFORD ROAD	the east side between its junction with Broad Lane (A10) and a point 4 metres south of the extended northernmost building line of Nos. 110 to 156 Broad Lane
1406	A10	Haringey	STAMFORD ROAD	the west side between its junction with Broad Lane (A10) and a point 5 metres north of the extended northernmost building line of Nos. 62 to 108 Broad Lane
1409	A10	Haringey	STATION ROAD	the north side between its junction with The Hale (A10) and a point 10 metres east of the extended western building line of No. 51 (PH), The Hale
1410	A10	Haringey	STATION ROAD	the south side between its junction with The Hale (A10) and a point 7 metres east of a point opposite the extended western building line of No. 51 (PH), The Hale

Side Roads Designation Order

Item no	Route no	Borough	Street name	Description
1415	A10	Haringey	STONELEIGH ROAD	the north side between its junction with High Road (A10) and a point 36 metres east of the extended western building line of No. 444 High Road
1416	A10	Haringey	STONELEIGH ROAD	the south side between its junction with High Road (A10) and a point 4 metres east of the extended eastern building line of Nos. 440 to 442 High Road
1417	A10	Haringey	TALBOT ROAD	the east side between its junction with Broad Lane (A10) and a point 6 metres north of the extended southern building line of No. 37 Broad Lane
1418	A10	Haringey	TALBOT ROAD	the west side between its junction with Broad Lane (A10) and a point 3 metres north of the extended southern building line of No. 35 Broad Lane
1419	A10	Haringey	THE AVENUE	the north-west side between its junction with Bruce Grove (A10) and a point 4 metres north-east of the extended north-eastern building line of No. 17 Bruce Grove
1420	A10	Haringey	THE AVENUE	the south-east side between its junction with Bruce Grove (A10) and a point 4 metres north-east of the extended north easternmost building line of No. 16 Bruce Grove
1421	A10	Haringey	THE ROUNDWAY	the south-west side between its junction with The Roundway (A10) and a point 18 metres east of the extended common boundary of Nos. 272 and 274 Risley Avenue
1422	A10	Haringey	THE ROUNDWAY	the north side between its junction with Great Cambridge Road (A10) and a point 6 metres east of the extended eastern building line of No. 169 The Roundway
1425	A10	Haringey	TOTTENHAM GREEN EAST	the north-east side between its junction with High Road (A10) and a point 10 metres north-west of the extended south-eastern building line of Nos. 1 to 17 Laseron House, Tottenham Green East

Side Roads Designation Order

Item no	Route no	Borough	Street name	Description
1426	A10	Haringey	TOTTENHAM GREEN EAST	the south-west side between its junction with High Road (A10) and a point 7 metres north-west of a point opposite the extended south easternmost building line of Nos. 1 to 17 Laseron House, Tottenham Green East
1427	A10	Haringey	TOTTENHAM GREEN EAST, SOUTH SIDE	the north side between its junction with High Road (A10) and a point 5 metres east of a point opposite the extended western building line of No. 296 High Road
1428	A10	Haringey	TOTTENHAM GREEN EAST, SOUTH SIDE	the south side between its junction with High Road (A10) and a point 3 metres west of the extended eastern building line of No. 296 High Road
1431	A10	Haringey	TOWN HALL APPROACH ROAD	the east side between its junction with High Road (A10) and a point 21 metres south of a point opposite the extended southern building line of Town Hall, Town Hall Approach Road
1432	A10	Haringey	TOWN HALL APPROACH ROAD	the west side between its junction with High Road (A10) and a point 19 metres south of the extended southern building line of Town Hall, Town Hall Approach Road
1438	A10	Haringey	TYNEMOUTH ROAD	the north side between its junction with Broad Lane (A10) and a point 4 metres west of the extended eastern building line of No. 153 Broad Lane
1439	A10	Haringey	TYNEMOUTH ROAD	the south side between its junction with Broad Lane (A10) and a point 4 metres west of the extended eastern building line of No. 151 Broad Lane
1449	A10	Haringey	WAKEFIELD ROAD	the east side between its junction with Broad Lane (A10) and a point 25 metres north of the extended northern building line of No. 73 Wakefield Road

Side Roads Designation Order

Item no	Route no	Borough	Street name	Description
1450	A10	Haringey	WAKEFIELD ROAD	the west side between its junction with Broad Lane (A10) and a point 15 metres north of a point opposite the extended common boundary of No. 40 Wakefield Road and No. 98 Rangemoor Road
1453	A10	Haringey	WALTHEOF GARDENS (EASTERN ARM)	the west side between its junction with The Roundway (A10) and a point 20 metres north of the extended northern building line of Morris House (surgery), Waltheof Gardens
1454	A10	Haringey	WALTHEOF GARDENS (WESTERN ARM)	the west side between its junction with The Roundway (A10) and a point 3 metres south of the extended northern building line of No. 47 Waltheof Gardens
1455	A10	Haringey	WALTHEOF GARDENS (WESTERN ARM)	the east side between its junction with The Roundway (A10) and a point 3 metres south of a point opposite the extended northern building line of No. 47 Waltheof Gardens
1456	A10	Haringey	WALTON ROAD	the east side between its junction with Broad Lane (A10) and a point 2 metres south of the extended northern building line of Nos. 2 to 24 Walton Road
1457	A10	Haringey	WALTON ROAD	the west side between its junction with Broad Lane (A10) and a point 4 metres south of a point opposite the extended northern building line of Nos. 2 to 24 Walton Road
1458	A10	Haringey	WARGRAVE AVENUE	the north-west side between its junction with High Road (A10) and a point 6 metres north-east of the extended north-eastern building line of No. 78 High Road
1459	A10	Haringey	WARGRAVE AVENUE	the south-east side between its junction with High Road (A10) and a point 4 metres north-east of the extended north-eastern building line of No. 76 High Road
1462	A10	Haringey	WEST GREEN ROAD	the north side between its junction with High Road (A10) and a point 1 metre east of the extended common boundary of Nos. 8 and 10 West Green Road

Side Roads Designation Order

Item no	Route no	Borough	Street name	Description
1463	A10	Haringey	WEST GREEN ROAD	the south side between its junction with High Road (A10) and a point 6 metres east of the extended common boundary of Nos. 1a to 1b West Green Road and No. 1 West Green Road
1469	A10	Haringey	WHITE HART LANE	the north-east side between its junction with Great Cambridge Road (A10) and a point 7 metres north-west of the extended common boundary of Nos. 356 and 358 White Hart Lane
1470	A10	Haringey	WHITE HART LANE	the south-west side between its junction with Great Cambridge Road (A10) and a point 7 metres south-east of the extended common boundary of Nos. 295 and 297 White Hart Lane
1471	A10	Haringey	WHITE HART LANE	the north-east side between its junction with Great Cambridge Road (A10) and a point 4 metres north-west of the extended north-western building line of No. 372 White Hart Lane
1472	A10	Haringey	WHITE HART LANE	the south-west side between its junction with Great Cambridge Road (A10) and a point 16 metres north-west of a point opposite the extended north-western building line of No. 372 White Hart Lane
1476	A10	Haringey	WOODSIDE GARDENS	the north-west side between its junction with Bruce Grove (A10) and a point 19 metres north-east of the extended south-western building line of No. 103 Bruce Grove
1477	A10	Haringey	WOODSIDE GARDENS	the south-east side between its junction with Bruce Grove (A10) and the extended north-eastern building line of No. 105 Bruce Grove
1478	A10	Haringey	WOODSIDE GARDENS	the north-west side between its junction with Bruce Grove (A10) and a point 15 metres south-west of the extended north easternmost building line of No. 13 Bruce Grove
1479	A10	Haringey	WOODSIDE GARDENS	the south-east side between its junction with Bruce Grove (A10) and a point 25 metres south-west of the extended north easternmost building line of No. 12 Bruce Grove

Side Roads Designation Order

Item no	Route no	Borough	Street name	Description
6031	A503	Haringey	ALBERT ROAD	the north-east side between its junction with Seven Sisters Road (A503) and a point 1 metre south-east of the extended south-eastern building line of No. 618 (PH), Seven Sisters Road
6032	A503	Haringey	ALBERT ROAD	the south-west side between its junction with Seven Sisters Road (A503) and a point 12 metres north-west of the extended common boundary of Nos. 1 and 2 Albert Road
6045	A503	Haringey	BERKELEY ROAD	the north-east side between its junction with Seven Sisters Road (A503) and a point 2 metres south-east of the extended north-western building line of Telephone Exchange, Seven Sisters Road
6046	A503	Haringey	BERKELEY ROAD	the south-west side between its junction with Seven Sisters Road (A503) and a point opposite the extended north-western building line of Telephone Exchange, Seven Sisters Road
6050	A503	Haringey	BIRSTALL ROAD	the north-east side between its junction with Seven Sisters Road (A503) and a point 8 metres south-east of a point opposite the extended north-western building line of No. 663 Seven Sisters Road
6051	A503	Haringey	BIRSTALL ROAD	the south-west side between its junction with Seven Sisters Road (A503) and a point 7 metres north of the extended south-eastern building line of No. 663 Seven Sisters Road
6062	A503	Haringey	CANDLER STREET	the north-east side between its junction with Seven Sisters Road (A503) and a point 5 metres north-west of the extended south-eastern building line of No. 1b Candler Street
6063	A503	Haringey	CANDLER STREET	the south-west side between its junction with Seven Sisters Road (A503) and a point 9 metres south-east of the extended north-western building line of Nos. 596 to 598 (Garage), Seven Sisters Road

Side Roads Designation Order

Item no	Route no	Borough	Street name	Description
6070	A503	Haringey	CULVERT ROAD	the north-east side between its junction with Seven Sisters Road (A503) and a point 6 metres south-east of the extended south-eastern building line of No. 597 Seven Sisters Road
6071	A503	Haringey	CULVERT ROAD	the south-west side between its junction with Seven Sisters Road (A503) and a point 10 metres south-east of a point opposite the extended south-eastern building line of No. 597 Seven Sisters Road
6076	A503	Haringey	DURNFORD STREET	the north-east side between its junction with Seven Sisters Road (A503) and a point 2 metres south-east of the extended south-eastern building line of No. 730 Seven Sisters Road
6077	A503	Haringey	DURNFORD STREET	the south-west side between its junction with Seven Sisters Road (A503) and a point 4 metres north-west of the extended north-western building line of Nos. 6 to 40 Durnford Street
6078	A503	Haringey	EADE ROAD	the north side between its junction with Seven Sisters Road (A503) and a point 35 metres north-east of a point opposite the extended western building line of Nos. 1 to 30 Vivian House, Eade Road
6079	A503	Haringey	EADE ROAD	the south side between its junction with Seven Sisters Road (A503) and a point 6 metres west of the extended north-eastern building line of Nos. 1 to 30 Vivian House, Eade Road
6083	A503	Haringey	ELIZABETH ROAD	the north-east side between its junction with Seven Sisters Road (A503) and a point 1 metre south-east of the extended north-western building line of No. 625 Seven Sisters Road
6084	A503	Haringey	ELIZABETH ROAD	the south-west side between its junction with Seven Sisters Road (A503) and a point 3 metres south-east of the extended north-western building line of No. 617 Seven Sisters Road
6089	A503	Haringey	GOURLLEY STREET	the north-east side between its junction with Seven Sisters Road (A503) and a point 1 metre south-east of the extended south-eastern building line of Nos. 718 to 720 Seven Sisters Road

Side Roads Designation Order

Item no	Route no	Borough	Street name	Description
6090	A503	Haringey	GOURLEY STREET	the south-west side between its junction with Seven Sisters Road (A503) and a point 7 metres south-east of the extended south-eastern building line of No. 716 Seven Sisters Road
6091	A503	Haringey	GREEN LANES	the west side between its junction with Seven Sisters Road (A503) and a point 7 metres north of a point opposite the extended south-eastern building line of No. 316 (PH) Manor House, Seven Sisters Road
6096	A503	Haringey	GREENFIELD ROAD	the north-east side between its junction with Seven Sisters Road (A503) and the extended northern building line of No. 645 Seven Sisters Road
6097	A503	Haringey	GREENFIELD ROAD	the south-west side between its junction with Seven Sisters Road (A503) and a point 6 metres north of the extended northern building line of No. 643 Seven Sisters Road
6104	A503	Haringey	HEYSHAM ROAD	the north-east side between its junction with Seven Sisters Road (A503) and a point 28 metres north-west of the extended north-western building line of Nos. 1 to 3 Heysham Road
6105	A503	Haringey	HEYSHAM ROAD	the south-west side between its junction with Seven Sisters Road (A503) and a point 1 metre south-east of the extended north-western building line of Telephone Exchange, Seven Sisters Road
6120	A503	Haringey	KERSWELL CLOSE	the south-east side between its junction with St Ann's Road and the extended south-western building line of No. 2 Kerswell Close
6123	A503	Haringey	MANCHESTER ROAD	the north-east side between its junction with Seven Sisters Road (A503) and a point 2 metres south-east of the extended north westernmost building line of No. 590 (Weights and Measures Office), Seven Sisters Road

Side Roads Designation Order

Item no	Route no	Borough	Street name	Description
6124	A503	Haringey	MANCHESTER ROAD	the south-west side between its junction with Seven Sisters Road (A503) and a point 2 metres south-east of a point opposite the extended north-western building line of No. 590 (Weights and Measures Office), Seven Sisters Road
6131	A503	Haringey	MORETON ROAD	the north-east side between its junction with Seven Sisters Road (A503) and a point 1 metre south-east of the extended north-western building line of No. 33 Moreton Road
6132	A503	Haringey	MORETON ROAD	the south-west side between its junction with Seven Sisters Road (A503) and a point opposite the extended north-western building line of No. 33 Moreton Road
6135	A503	Haringey	NETHERTON ROAD	the north-east side between its junction with Seven Sisters Road (A503) and a point 6 metres north-west of a point opposite the extended south-eastern building line of No. 379 Seven Sisters Road
6136	A503	Haringey	NETHERTON ROAD	the south-west side between its junction with Seven Sisters Road (A503) and a point 6 metres north-west of the extended south-eastern building line of No. 379 Seven Sisters Road
6167	A503	Haringey	ST ANNS ROAD	the north-east side between its junction with Seven Sisters Road (A503) and a point 8 metres south-west of the extended south-western building line of No. 2 Kerswell Close
6168	A503	Haringey	ST ANNS ROAD	the south-west side between its junction with Seven Sisters Road (A503) and a point 2 metres south-east of the extended common boundary of Nos. 2 and 3 Suffolk Road
6169	A503	Haringey	ST ANNS ROAD	the north-east side between its junction with Seven Sisters Road (A503) and a point 30 metres north-west of the extended north westernmost building line of Community Church of God, St Ann's Road

Side Roads Designation Order

Item no	Route no	Borough	Street name	Description
6170	A503	Haringey	ST ANN'S ROAD	the south-west side between its junction with Seven Sisters Road (A503) and a point 51 metres south-east of the intersection of the extended south-western kerbline of St Ann's Road and the extended south-eastern kerbline of Seven Sisters Road
6182	A503	Haringey	STONEBRIDGE ROAD	the north-east side between its junction with Seven Sisters Road (A503) and a point 2 metres south-east of a point opposite the extended north-western building line of Nos. 778 to 796 Seven Sisters Road
6183	A503	Haringey	STONEBRIDGE ROAD	the south-west side between its junction with Seven Sisters Road (A503) and a point 4 metres north-west of the extended north-western building line of Nos. 778 to 796 Seven Sisters Road
6184	A503	Haringey	STONEBRIDGE ROAD	the south-west side between its junction with Seven Sisters Road (A503) and a point 16 metres north-west of the extended north westernmost building line of No. 1 Stonebridge Road
6185	A503	Haringey	STONEBRIDGE ROAD	the north-east side between its junction with Seven Sisters Road (A503) and a point 7 metres north-west of the extended north-western building line of Nos. 800 to 818 Seven Sisters Road
6187	A503	Haringey	STROUD GREEN ROAD	the north-east side between its junction with Stroud Green Road and Station Place and a point 47 metres north-west of the extended north-western building line of Nos. 2 to 8 Stroud Green Road
6188	A503	Haringey	SUFFIELD ROAD	the north-east side between its junction with Seven Sisters Road (A503) and a point 1 metre north-west of the extended north-western building line of No. 709 Seven Sisters Road
6189	A503	Haringey	SUFFIELD ROAD	the south-west side between its junction with Seven Sisters Road (A503) and a point 7 metres north-west of the extended south-eastern building line of No. 707 Seven Sisters Road

Side Roads Designation Order

Item no	Route no	Borough	Street name	Description
6196	A503	Haringey	VARTRY ROAD	the north-east side between its junction with Seven Sisters Road (A503) and a point 45 metres north-west of a point opposite the extended south-eastern building line of No. 188, Woodberry Down Baptist Church, Vartry Road
6197	A503	Haringey	VARTRY ROAD	the south-west side between its junction with Seven Sisters Road (A503) and a point 26 metres north-west of the extended south-eastern building line of No. 188 (Woodberry Down Baptist Church), Vartry Road
6202	A503	Haringey	WESTERFIELD ROAD	the north-east side between its junction with Seven Sisters Road (A503) and a point 7 metres north-west of the extended south-eastern building line of No. 687 Seven Sisters Road
6203	A503	Haringey	WESTERFIELD ROAD	the south-west side between its junction with Seven Sisters Road (A503) and a point 6 metres north-west of the extended south-eastern building line of Sorting Office, Seven Sisters Road
7063	B519	Haringey	KENWOOD ROAD	the north-west side between its junction with North Hill (B519) and a point 7 metres south-west of the extended north easternmost building line of No. 205 North Hill
7064	B519	Haringey	KENWOOD ROAD	the south-east side between its junction with North Hill (B519) and a point 8 metres south-west of the extended north easternmost building line of No. 203 North Hill
7065	B519	Haringey	NORTH HILL	the south-west side between its junction with North Hill and Kenwood Road and the extended common boundary of Nos. 199 and 201 North Hill
7066	B519	Haringey	NORTH HILL	the north-east side between its junction with North Hill and Baker's Lane and a point 2 metres north-west of the extended common boundary of Nos. 84 and 86 North Hill